

INDOOR STAND MIST FAN

INSTRUCTION MANUAL



Dear consumer, Please read these instructions carefully before use in order to avoid damage due to incorrect use and to better understand the functions of this product. Please pay particular attention to the safety guide.

If you pass the device on to a third party, these Operating Instructions must also be handed over.

Please keep them for future references.



IMPORTANT SAFEGUARDS

- ❑ Please read these instructions carefully before use.
- ❑ Keep present instructions for future references.
- ❑ Check that your mains voltage corresponds to that stated on the appliance.
- ❑ Only use the appliance for domestic purposes and household or similar applications such as:
 - staff kitchen areas, in shops, offices and other working environments;
 - by clients in hotels, motels and other residential type environments;
 - Environment type like :
 - Farm Houses • Bed and Breakfast.
- ❑ Only use the appliance in the way indicated in these instructions.
- ❑ Never use this unit near bathtub, shower, wash-hand basins or other containers with water.
- ❑ Never use this apparatus near water projections.
- ❑ Never use this apparatus with the wet hands.
- ❑ If, unfortunately the apparatus is wet, immediately withdraw the cord of the socket-outlet.
- ❑ Inform potential users of these instructions.
- ❑ Never leave the appliance unsupervised when in use.
- ❑ The appliance must be used only for its intended purpose. No responsibility can be taken for any possible damage caused by incorrect use or improper handling.
- ❑ Children and persons with disabilities are not always aware of the danger posed by the use of appliances.

- This device can be used by children aged 8 years and older and adults, with reduced physical, sensory or mental capabilities or lack of experience and knowledge, if they have been given supervision or instruction concerning use of the appliance in a safe way and understand the hazards involved.
- Cleaning and maintenance must not be made by children without supervision.
- Keep the appliance and its cord out of reach of children aged less than 8 years of age when it is energized or cooling down.
- This device is not a toy, do not leave children or people with disabilities to play with.
- In order to ensure your children's safety, please keep all packaging (plastic bags, boxes, polystyrene etc.) out of their reach.
- Warning! Never use without the guards in place. After assembly, do not remove the guards for maintenance purpose or cleaning.
- Caution! Do not allow small children to play with the foil:

THERE IS A DANGER OF SUFFOCATION!

- From time to time check the cord for damages. Never use the appliance if cord or appliance shows any signs of damage.
- Never immerse the appliance in water or any other liquid for any reason whatsoever.
- Never place it into the dishwasher.
- Never use the appliance near hot surfaces.
- Do not operate the appliance with a damaged cord or plug, or after the appliance has been damaged in any manner.
- If the supply cord or appliance is damaged, it must be replaced by the manufacturer or its service agent or a similarly qualified person in order to avoid a hazard.

- ❑ Disconnect the power source cable before any operation of cleaning of maintenance and accessories assembly.
- ❑ Disconnect the power source cable when filling and cleaning
- ❑ Never use the appliance outside and always place it in a dry environment.
- ❑ Never use accessories, which are not recommended by the producer. They could constitute a danger to the user and risk to damage the appliance.
- ❑ Never use any other connector than the one provided.
- ❑ Never move the appliance by pulling the cord. Make sure the cord cannot get caught in any way.
- ❑ Never wind the cord around the appliance and do not bend it
- ❑ Ensure that the power cord does not come into contact with hot parts of this unit.
- ❑ Make sure the appliance has cooled down before cleaning and storing it.
- ❑ The temperature of accessible surfaces may be very high when the appliance is operating. Never touch these parts, of apparatus, to avoid burning itself.
- ❑ Make sure the appliance never comes into contact with flammable materials, such as curtains, cloth, etc...& the power cord and plug do not come in contact with water.
- ❑ Before cleaning, always unplug the appliance from the power supply and let it cool down.
- ❑ This appliance is not intended to be operated by means of an external timer or separate remote-control system.
- ❑ Always place the unit on a flat surface. Ensure, also, not to cover the device and not to put anything on it.
- ❑ Always remove the plug from the wall socket when the appliance is not in use.
- ❑ When using an extension lead always make sure that the entire cable is unwound from the reel. Use solely CE

approved extension leads. Input power must be at least 16A, 250V, 3000W.

- ❑ Incorrect operation and improper use can damage the appliance and cause injury to the user.
- ❑ This device, designed for home use, complies with standards relating to this type of product.
- ❑ The appliance must be used and rested on a table or flat & stable surface.
- ❑ The item must not be left unattended when it is connected to main supply.
- ❑ The item is not to be used, if it has been dropped or if there are visible signs of damage.
- ❑ This appliance is only intended for household use.
- ❑ Regarding filling, cleaning and descaling, please refer to below paragraphs.

SPECIFIC SAFETY REQUIRED FOR THIS PRODUCT

1. Use the fan always set it on a flat surface.
2. Do not carry the device by holding the power cord.
3. Do not insert objects through the protective grill.
4. Do not use the device in a bathroom
5. Always use the fan with the included foot and upright.
6. Do not use near curtains etc.

No warranty will be applied if the appliance is used for other than its intended use.

GENERAL INFORMATION

The symbol "OPEN BOOK" means a recommendation to read important things contained in the record.

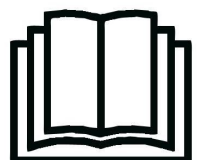

The symbol "BIN" crossed out, abbreviation WEEE (Waste of Electrical and Electronic Equipment) means that at the end of life, it should not be discarded with household waste, but filed to the sorting of the locality. Waste recovery can help preserve our environment.



The symbol "CE" is the guarantee of compliance with harmonized European standards, voluntary, reflecting the essential requirements into technical specifications. These standards are not mandatory but are guarantees of compliance with essential requirements.



The symbol ROHS (Restriction of use of some Hazardous Substances) on the Environmental Protection, certifies that for each of the five hazardous substances • Lead • Mercury • (hexavalent) chromium • products for protection against flames PBB and PBDE, the peak concentration is equal to or less than 0.1% of the weight of homogeneous material, and 0.01% for the 6th • cadmium.



The symbol "DOUBLE SQUARE" means a double insulated. A basic insulation and supplementary insulation. This device requires no connection to the mass of a protective conductor grounded. The materials are said : double insulation class II.

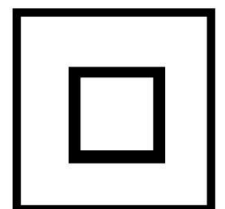

Appliance for tropical climates.



The symbol "TRIMAN" indicates that the consumer is invited to dispose the product as part of a separate



collection (eg recycling bin, waste, voluntary intake point).

For more information : <http://www.quefairedemesdechets.fr>

TO KNOW IT'S UNIT

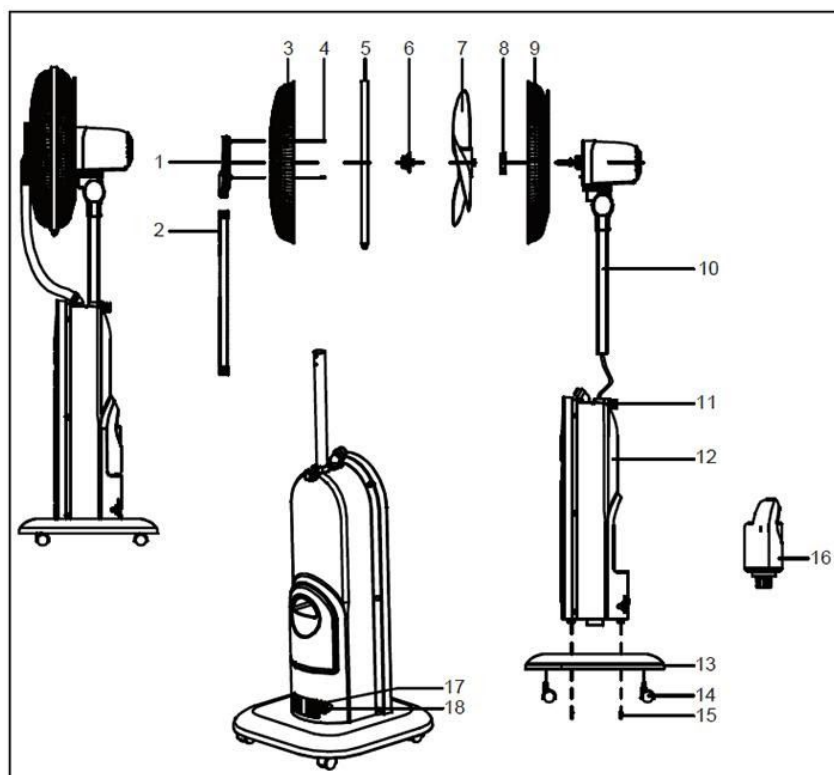

1. Misting outlet (nozzle)
2. Diffuser tube of the atomiser

3. Front grille
4. Fixing nozzle on the grid

- 5. Clamp
- 6. Fixing Nut of the blades
- 7. Blades
- 8. Fixing Nut of the rear grille
- 9. Rear grille
- 10. Engine and its support
- 11. Nut for attaching the motor base to the device
- 12. Back of the device

- 13. Base of the device
- 14. Casters
- 15. Fixing Screws base / device
- 16. Water tank
- 17. Spring pliers
- 18. Drain plug

Assembling

Assembling the device

- 1. Remove the engine and the column from the packing box.
- 2. Insert the connection wire and tube into the column.
- 3. Tighten the fastening knob. Figure 1.

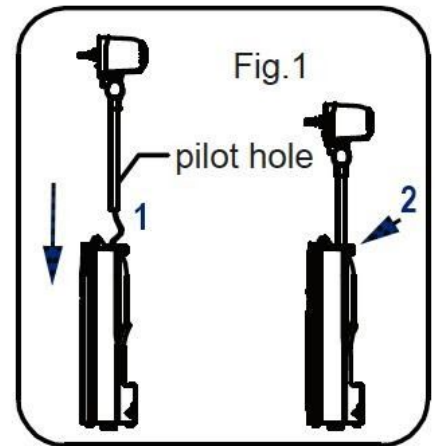

Assembly of the casters

- 1. Remove the base and the casters from the packing box.
- 2. Depress the casters by inserting the shafts into the mounting holes in the base. Figure 2

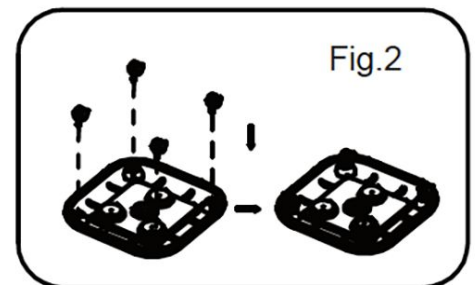

Assembly of the base on the column

- 1. Put the 3 screws in the holes of the base, and screw them into the nuts embedded in the bottom of the column. Figure 3

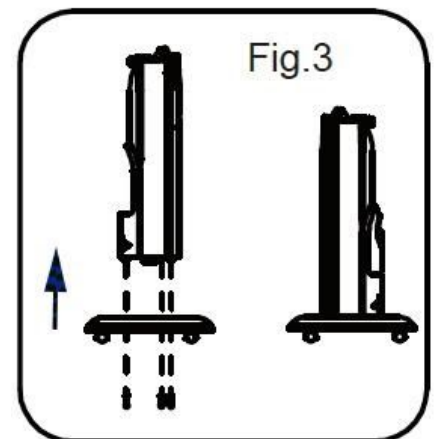

Assembly of the rear grille and blades

- 1. Mount the rear grille on the motor shaft.
- 2. Tighten the protection nut,

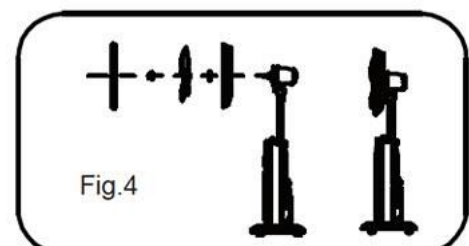

3. Mount the blades on the motor shaft and tighten the fixing nut.
4. Engage the clamp (but do not tighten) on the rear rack. Figure 4

Front grille and sprayer assembly

1. Insert the spray tip of atomiser into the diffusion tube.
2. Secure the set tube / nozzle to the front grille with the screws. Figure 5

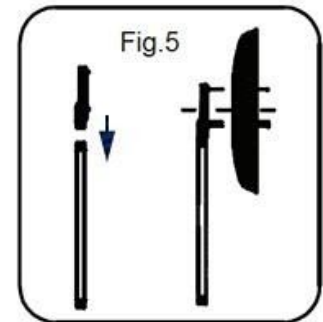

Fit the front grille and the diffuser

2. Mount the front grille on the rear grille and position the clamp in the middle. Tighten the collar.
3. Insert the bottom of the diffusion tube onto the top of the column. Figure 6.

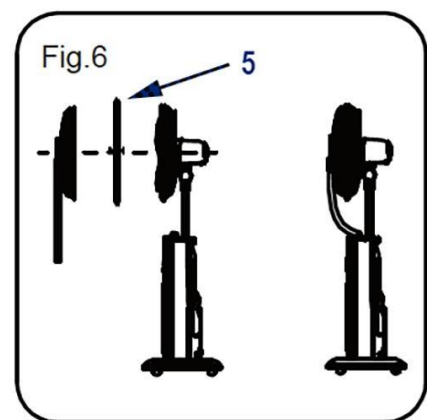

USE

- Unwind the power cord completely.
- Check that the voltage in the country where you are, corresponds to that indicated on the device.
- Connect the appliance to a good electrical outlet, (earthed if the appliance is class I), to avoid any danger.
- Disconnect the power cable from the power supply before performing any maintenance cleaning and accessory fitting.
- Never modify the device.

After switching on, the buzzer beeps and the indicator light comes on.

ON OFF

By pressing the On / Off button, the fan enters Normal mode. "

The operation at the lowest level is the one used and the ambient temperature is displayed on the screen.

By pressing the button again the fan power is disconnected and the fan stops.

SPEED

Fan speed control by pressing:
"Speed +" or "speed -"

TIMER

Fan timer switch; it works in the following order: 1H-2H-4H-8H and back to 0.

MIST

Humidification switch; see paragraph: MISTING.

MODE

Ventilation cycle type selector; it operates in the following order : Normal ventilation - Natural ventilation - Night ventilation Return to Normal ventilation.

ECO / TEMP

Intelligent ventilation function; by pressing this function, the fan automatically selects an appropriate level according to the temperature change according to programming.

OSC

Oscillation switch: It controls rotation from left to right and back.

MIST

Instructions for using the humidification or misting function.

- Remove the water tank from the unit and unscrew the tank cap counter clockwise.
- Fill with fresh and cold water. Never put water above 40 ° C and screw on the water tank cap.
- Check that there are no leaks.



- Replace the water tank in the appliance (return to its location according to the angle of the drawing), and wait a few minutes for the buffer tank in the appliance to fill with water.



- Press the "Misting" button, the indicator light comes on indicating the beginning of fogging.

Note: If the indicator flashes (and goes out after 10 seconds), it indicates a lack of water or a low water level. (Check that the tank float of the unit is placed correctly.)

PRECAUTIONS

Before first use, check that the unit has been assembled correctly.

- Before turning on the power, check that the voltage used is the same than that indicated on the plate of the apparatus.
- When the appliance is working, do not insert fingers or objects through the grill or into the body of the machine.
- When using a mosquito repellent product, make sure that it is out of reach of children, and if it is accidentally swallowed, seek immediate medical attention.
- When the humidifier is used, the water tank should use clean soft water below 40 °. If possible, it is recommended to use deionized water or distilled water containing less impurities.
- Do not place this unit on a sloping floor to prevent tipping, and, do not remove the water tank when the humidifier is running.

If the device accidentally spills when it contains water,

1. Unplug the power cord.
 2. Remove the water tank
 3. Check that there is no water accumulated in the unit before reuse.
- When using the humidifier:
Do not add disinfectant, vinegar, perfume or essential oils.
Never fog in front of furniture, appliances or near walls to avoid excessive moisture damage.
Change the water every 2 days, because the water, in the water tank, can easily generate bacteria.
Clean the tank every 2-3 weeks.
- NOTE: The unit is intended for indoor use.

Before cleaning the Mist fan:

- Cut off the power,
Remove the spring clip and the drain plug, and clean the remaining water in the unit.
- Note: After use for a while, the float and the inside of the tank of the device are subject to the accumulation of limestone or scale.
Put hot water and a small amount of detergent in the tank of the device, soak for about 30 minutes then rinse with clean water several times.
- Re-Screw in the drain plug and refit the spring clip.
 - Do this cleaning after heavy or continuous use.
Allow the machine to dry in the shade before re-use.

1. On / Off
2. Timer
3. Mode: Normal - Natural - Night
4. Speed selector 1/2/3
5. Control of the Oscillation
6. Misting control
7. Infrared sensor



CLEANING AND MAINTENANCE

- Always unplug the appliance and allow it to cool before cleaning.
- Clean the outside of the appliance with a slightly damp sponge or cloth.
- Never immerse the appliance in water or any other liquid!
- Never use abrasive products, wire brushes or other sharp objects.
- The front and rear grilles can be cleaned with a brush or a soft, damp cloth.
- The motor housing and feet can be cleaned with a soft, damp cloth.
- Use only original accessories.
- Grasp the appliance only by the handle provided.

STORAGE

- Ensure the unit is completely cool and dry.
- Do not wrap the cord around the appliance, as this will cause damage.
- Keep the appliance in a cool, dry place and out of reach from children.

GUARANTEE

Before being delivered, all our products are subjected to a rigorous control. This apparatus is guaranteed 24 months starting from the date of purchase by the consumer.

The documents in proof of guarantee are:

- The invoice and
- The filled and stamped warranty plate (located on side or bottom of the gift box). Without these documents in proof, no free replacement, nor no free repair, can be carried out.

During the warranty period, we deal for free, the defects of the apparatus or the accessories, rising from a defect of materials or manufacture by repair or, replacement. The services within the framework of the guarantee do not involve any extension of the warranty period and does not give right to a new guarantee! In the event of recourse to the guarantee, bring back the complete apparatus to your retailer, in its original packing, accompanied by the proofs of purchase.

The breakage of parts out of glass or plastic is, in all the cases, not warranted. Defects on the accessories or the wearing parts (for example: coils of engines, hooks, drive belts, remote control of replacement, teeth brushes of replacement, webs etc) as well as cleaning, maintenance or it replacement of wearing parts are not guaranteed and are thus to pay!

In the event of foreign intervention, the guarantee becomes null and void.

After flow of the warranty period, repairs can be carried out, against payment, by a specialized trade or a repair service.

SPECIFICATIONS

Power supply	220-240V~ 50Hz
Power	95W
Norm	Class II
Maximum fan flow rate	69.66 m ³ /min
Fan power input	42.30W
Service value	1.65 (m ³ /min)/W
Standby power consumption	0.15
Season electricity consumption	13.70 kWh/a
Fan sound power level	58.22 dB(A)
Maximum air velocity	2.89 meters/sec
Measurement standard for Service value	COMMISSION REGULATION (EU) No 206/2012 & (EU) 2016/2282 2009/125/EC IEC 60879: 1986 (corr, 1992) EN 60704-2-7: 1998 EN 60704-1: 2010+A11: 2012 EN 50564: 2011

MADE IN PRC

The characteristics can change without preliminary preventing

CAUTION: In order to minimize the risks of electric shock, In the event of breakdown, not to open the case but to call upon a qualified technician for repairs.

This apparatus satisfied EC directives, it was controlled according to all the European current directives, like: electromagnetic compatibility (EMC) and low tension (LVD).

This apparatus was designed and manufactured in respect of the last safety regulations and technical specifications.

**Imported by Sotech International
" LE PERIPOLE " N°A107
33, Avenue du Marechal de Lattre de Tassigny
94120 Fontenay sous bois - France**

