

RECHARGEABLE HAIR CLIPPER INSTRUCTION MANUAL



TTS-03



TTS-05



TTS-07



TTS-08



Dear consumer, Please read these instructions carefully before use in order to avoid damage due to incorrect use and to better understand the functions of this product. Please pay particular attention to the safety guide.

If you pass the device on to a third party, these Operating Instructions must also be handed over.

Please keep them for future references.

IMPORTANT SAFEGUARDS

- Please read these instructions carefully before use.
- Keep present instructions for future references.
- Check that your mains voltage corresponds to that stated on the appliance.
- Only use the appliance for domestic purposes and household or similar applications such as:
 - staff kitchen areas, in shops, offices and other working environments;
 - by clients in hotels, motels and other residential type environments;
 - Environment type like :
 - Farm Houses • Bed and Breakfast.
- Only use the appliance in the way indicated in these instructions.
- Never use this unit near bathtub, shower, wash-hand basins or other containers with water.
- Never use this apparatus near water projections.
- Never use this apparatus with the wet hands.
- If, unfortunately the apparatus is wet, immediately withdraw the cord of the socket-outlet.
- Inform potential users of these instructions.
- Never leave the appliance unsupervised when in use.
- The appliance must be used only for its intended purpose. No responsibility can be taken for any possible damage caused by incorrect use or improper handling.
- Children and persons with disabilities are not always aware of the danger posed by the use of appliances.
- This appliance can be used by children aged from 8 years and above and persons with reduced physical, sensory or mental capabilities or lack of experience and knowledge, if they have been given supervision or instruction concerning

use of the appliance in a safe way and understand the hazards involved.

- Children shall not play with the appliance.
- Cleaning and maintenance must not be made by children without supervision.
- Keep the appliance and its cord out of reach of children aged less than 8 years.
- This device is not a toy, do not leave small children or people with disabilities to play with.

Keep the appliance dry.

- The appliance is only to be used with the power supply unit provided with the appliance.
- The appliance must only be supplied at safety extra low voltage corresponding to the marking on the appliance.
- In order to ensure your children's safety, please keep all packaging (plastic bags, boxes, polystyrene etc.) out of their reach.
- Caution ! Do not allow small children to play with the foil :
THERE IS A DANGER OF SUFFOCATION !
- From time to time check the cord for damages. Never use the appliance if cord or appliance shows any signs of damage.
- Never immerse the appliance in water or any other liquid for any reason whatsoever.
- Never place it into the dishwasher.
- Never use the appliance near hot surfaces.
- Disconnect the power source cable before any operation of cleaning of maintenance and accessories assembly.
- Never use the appliance outside and always place it in a dry environment.
- Never use accessories, which are not recommended by the producer. They could constitute a danger to the user and risk to damage the appliance.
- Never use any other connector than the one provided.

- ❑ Never move the appliance by pulling the cord. Make sure the cord cannot get caught in any way.
- ❑ Never wind the cord around the appliance and do not bend it
- ❑ Ensure that the power cord does not come into contact with hot parts of this unit.
- ❑ Make sure the appliance has cooled down before cleaning and storing it.
- ❑ The temperature of accessible surfaces may be very high when the appliance is operating. Never touch these parts, of apparatus, to avoid burning itself.
- ❑ Make sure the appliance never comes into contact with flammable materials, such as curtains, cloth, etc...& the power cord and plug do not come in contact with water.
- ❑ Before cleaning, always unplug the appliance from the power supply and let it cool down.
- ❑ This appliance is not intended to be operated by means of an external timer or separate remote-control system.
- ❑ Always place the unit on a flat surface. Ensure, also, not to cover the device and not to put anything on it.
- ❑ Always remove the plug from the wall socket when the appliance is not in use.
- ❑ When using an extension lead always make sure that the entire cable is unwound from the reel. Use solely CE approved extension leads. Input power must be at least 16A, 250V, 3000W.
- ❑ Incorrect operation and improper use can damage the appliance and cause injury to the user.
- ❑ This device, designed for home use, complies with standards relating to this type of product.
- ❑ Regarding the instructions for cleaning, thanks to refer to the below paragraph of the manual.
- ❑ This appliance is only intended for household use.

GENERAL INFORMATION

The symbol "OPEN BOOK" means a recommendation to read important things contained in the record.

The symbol "BIN" crossed out, abbreviation WEEE (Waste of Electrical and Electronic Equipment) means that at the end of life, it should not be discarded with household waste, but filed to the sorting of the locality. Waste recovery can help preserve our environment.

The symbol "CE" is the guarantee of compliance with harmonized European standards, voluntary, reflecting the essential requirements into technical specifications. These standards are not mandatory but are guarantees of compliance with essential requirements.

The symbol ROHS (Restriction of use of some Hazardous Substances) on the Environmental Protection, certifies that for each of the five hazardous substances • Lead • Mercury • (hexavalent) chromium • products for protection against flames PBB and PBDE, the peak concentration is equal to or less than 0.1% of the weight of homogeneous material, and 0.01% for the 6th • cadmium.

The symbol "III" means that the equipment concerned is designed to be supplied at a voltage of not more than 50 volts AC or 120 volts DC. Materials with this sign are classified as Class III.

The symbol "TUB / SHOWER" crossed out means to never use the unit in a bathroom, a shower in or near water spray.

The symbol "TRIMAN" indicates that the consumer is invited to dispose the product as part of a separate collection (eg recycling bin, waste, voluntary intake point).

For more information : <http://www.quefairedemesdechets.fr>

PARTICULAR WARNING FOR PRODUCT USE IN A BATHROOM

- Switch off when not in use, even if for a moment.
- Unplug it after use, since the proximity of water presents a hazard, even when the unit is switched off.
- Do not use this product while taking a shower or bath. Always unplug the device even close between 2 uses.
- When the unit is used in a bathroom unplug it after use since the proximity of water presents a risk, even when the power is off.
- To provide additional protection, in the electrical circuit supplying the bathroom, a residual current device (RCD) with a rated residual current not exceeding 30mA operation, is recommended. Consult your installer.

NOTE: A thermal fuse, is not a residual current device (RCD).

- Do not use this product while taking a shower or bath.
- Always unplug the unit itself between two closely spaced uses.
- For example: Stop the machine and unplug it if you drop it while you dry.

READ ALL INSTRUCTIONS BEFORE USING AND SAVE THESE INSTRUCTIONS

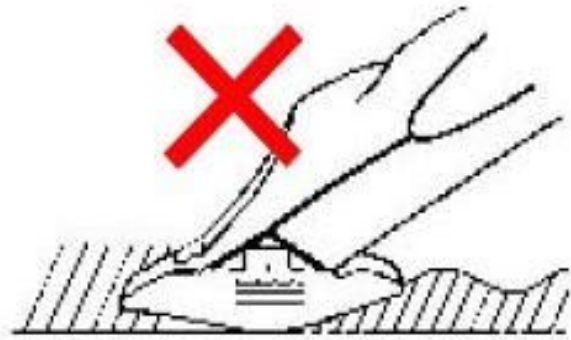
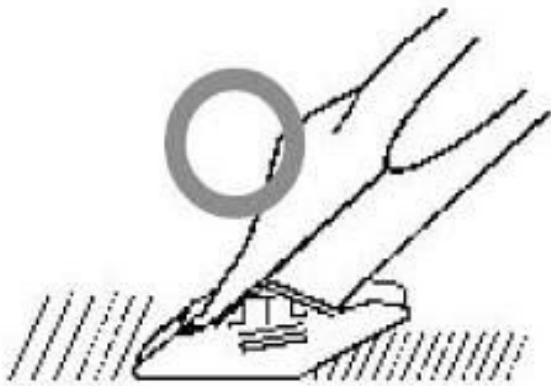

Special safety instructions for this device

- Use this machine to cut dry hair only.
- Use this machine to cut only hair and beards.
- Do not charge the machine in a humid atmosphere.
- When charging keep the machine AWAY from direct sunlight or sources of heat.
- Do not press the cutting head too much against the skin. Danger of injury!
- NEVER use any adapter other than that supplied with the machine.

TO CHARGE THE BATTERY

Put the ON/OFF switch on Off position

Plug the adaptor in a wall socket

The Control light turn on and the appliance start to be charge

The full charge is obtained with 8h charging.

Notes : - Don't charge more than 8H

- Twice a year fully re charge the unit for 8H !

- When fully charged the device has a maximum operating time of 25 minutes.

- After this time, it must be switched off and allowed to cool down for 10 minutes.

- The charging LED lights up during the charging procedure.

- Never use this product on wet hair.

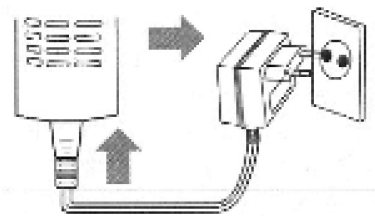

GUIDE FOR CUTTING HAIR AT HOME

Never use the product to cut wet hair, It is designed to work in dry condition only.

BEFORE YOU BEGIN

- Make sure that your clipper is clean, properly oiled and perfect working condition.
- Place a towel around the neck of the person to prevent hair from falling down inside the collar.
- Position the person whose hair is to be cut on a chair so that his/her head is at your eye's level.
- Comb the hair to remove all tangles, hold the clipper in a relaxed comfortable grip. This will help you to maintain an accurate cutting control.

CUTTING HAIR WITH COMB

(For medium or longer cuts)

To attach a comb, snap it into the mower head.

The small comb has teeth of 3 and 6mm.

The large comb with teeth of 9 and 12 mm



To start, cut the hair on a small area to check the length of hair left by the comb.

Notes: It is advisable to first to use the longest comb and then move to a shorter comb if necessary.

For a uniform cut, do not force or push the trimmer into hair quickly. The clipper works best on its own speed.

Start by combing the hair in its natural direction,

Place the largest, attachment comb onto your clipper and start by trimming the sides from the bottom upwards.

Hold the clipper lightly against the hair with teeth of the attachment comb pointing up but flat against the head.

Slowly lift the clipper up and outward through the hair, cutting only a small amount at a time.(Fig. 1)

Repeat around sides and back of head.(Fig.2)

If you desire shorter hair, either change to a lower number attachment comb or apply more pressure and less lift away from head with the present attachment comb.

This entire procedure requires practice, and it is always better to leave too much hair the first few haircuts.(Fig.3)

For the top of the head, you will give a fairly short cut if you use the smaller comb. With the teeth flat against the head, slowly start trimming from the front to the back. Again, it is better to leave the hair longer the first few haircuts. (Fig.4)



Fig



Fig



Fig



Fig

.4

Outlining

Outlining requires no attachment. Take the clipper and push the lever up to the close-cut position.

Comb hair into the style. Position clipper between the side burns and the ear. (Fig. 5)

Make sure the corner edge of the blade is against the hairline. With the outline of the hair as your guide, slowly move the clipper over, around, and behind the ears. (Fig.6)

For the back of the neck and the sideburns, hold the clipper upside down, (see sketch), and holding it against the skin at the length desired, move downwards.



Fig



Fig

.6

Short cuts to perfect flat tops, crew cuts

Always cut from the back of the neck to the crown, using the longest attachment comb. Holding it flat against the head, slowly move the clipper up through the hair.

Use the same technique for the sides, cutting from the bottom to the upper side of the head. (Fig.7)

For the front to the crown, cut the hair against the direction in which it grows. Then even it up with the sides. (Fig.8)

For a flat top, use a flat comb, not the attachment comb. Just cut hair on top of the head over it.



Fig

.7



Fig

.8

To taper hair down to the neckline, use closer cutting attachment combs. Comb hair and check for uneven spots and outline sideburns and neckline. (Fig.9)



Fig
.9

If a short-tapered cut on the sides and back is desired, follow the diagram below:

The four basic areas illustrated on the hair cutting guide are easy do-it-yourself hair cutting.

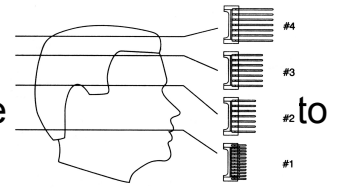

MAINTENANCE

1. Hold the trimmer with the observe side facing downwards and push the blade away from the housing.
2. Press the swing knob to spread the blades detached apart for cleaning
3. Add one or 2 drops of oil to the blades.

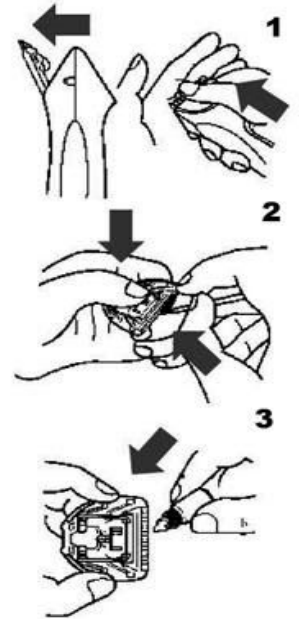

The regular cleaning and maintenance of the machine will guarantee optimal results and a long life.

- Use only a slightly damp and soft cloth to clean the machine.
- After use remove each time all hair left on the machine with the supplied brush.
- Remove the cutting comb and the cutting head to either blow off the hair particles or brush them off with the cleaning brush.
- After using the machine apply each time 1-2 drops of an acid-free oil , Special oil or sewing machine oil, on the cutting head.

CLEANING AND MAINTENANCE

Before cleaning switch off the appliance

Always disconnect the apparatus and to let it cool before cleaning.

Clean the outside of the apparatus with a sponge or slightly wet linen.

Never plunge the apparatus in water or all other liquid !

Do not use abrasive cleaners, gritting, or metal brush or another cutting object.

OILING BLADES

To maintain the mower in good condition, the blades should be oiled regularly.

STORAGE

- Ensure the unit is completely cool and dry.
- Do not wrap the cord around the appliance, as this will cause damage.
- Keep the appliance in a cool, dry place.

GUARANTEE

Before being delivered, all our products are subjected to a rigorous control. This apparatus is guaranteed 24 months starting from the date of purchase by the consumer.

The documents in proof of guarantee are :

- The invoice and
- The filled and stamped warrantee plate (located on side or bottom of the gift box). Without these documents in proof, no free replacement, nor no free repair, can be carried out.

During the warranty period, we deal for free, the defects of the apparatus or the accessories, rising from a defect of materials or manufacture by repair or, replacement. The services within the framework of the guarantee do not involve any extension of the warranty period and does not give right to a new guarantee ! In the event of recourse to the guarantee, bring back the complete apparatus to your retailer, in its original packing, accompanied by the proofs of purchase.

The breakage of parts out of glass or plastic is, in all the cases, not warranted. Defects on the accessories or the wearing parts (for example: coals of engines, hooks, drive belts, remote control of replacement, teeth brushes of replacement, webs etc) as well as cleaning, maintenance or it replacement of wearing parts are not guaranteed and are thus to pay !

In the event of foreign intervention, the guarantee becomes null and void.

After flow of the warranty period, repairs can be carried out, against payment, by a specialized trade or a repair service.

SPECIFICATIONS

Clipper

| | |
|--------------|--------------------------------------|
| Power supply | 1,2V DC |
| Power | 3W |
| Battery | 1 rechargeable Ni-Mh 600mA/h Battery |
| Norm | Class III |

Adapter

| | |
|--------------|--------------------------|
| Power supply | 230V~ 50Hz / DC 3V 300mA |
| Norm | Class II |

Made in PRC

The characteristics can change without prior notice

CAUTION: In order to minimize the risks of electric shock, In the event of breakdown, not to open the case but to call upon a qualified technician for repairs.

This device complies with EC directives, it was controlled according to all current European directives, applicable such as: electromagnetic compatibility (EMC) and low voltage (LVD).

This device has been designed and manufactured in compliance with the latest regulations and technical requirements for safety.

ENVIRONMENTAL PROTECTION

(Destruction of batteries)

To remove the battery:

- Open the battery compartment and retrieve the battery or batteries.
 - THE BATTERY MUST BE REMOVED BEFORE THE UNIT IS GIVEN TO REBUS.
 - BATTERY CONTAINS NICKEL CADMIUM AND / OR LITHIUM AND / OR NICKEL-METAL HYDRIDE, THE BATTERY MUST BE ELIMINATED IN A SAFE WAY.
- DO NOT THROW IN A TRASH CAN, BUT GIVE IN CENTRE OF WASTE.

**Imported by Sotech International
" LE PERIPOLE " N°A-107
33, Avenue du Marechal de Lattre de Tassigny
94120 Fontenay sous bois - France**