

### DUST & ASHES AND BLOWER CAN VACUUM CLEANER

#### Instruction manual



Dear consumer, Please read these instructions carefully before use in order to avoid damage due to incorrect use and to better understand the functions of this product. Please pay particular attention to the safety guide.

If you pass the device on to a third party, these Operating Instructions must also be handed over.

## IMPORTANT SAFEGUARDS

- ❑ Please read these instructions carefully before use.
- ❑ Keep present instructions for future references.
- ❑ Check that your mains voltage corresponds to that stated on the appliance.
- ❑ Only use the appliance for domestic purposes and household or similar applications such as:
  - Staff kitchen areas, in shops, offices and other working environments;
  - By clients in hotels, motels and other residential type environments;
  - Environment type like :
    - Farm Houses • Bed and Breakfast.
- ❑ Only use the appliance in the way indicated in these instructions.
- ❑ Never use this unit near bathtub, shower, wash-hand basins or other containers with water.
- ❑ Never use this apparatus near water projections.
- ❑ Never use this apparatus with the wet hands.
- ❑ If, unfortunately the apparatus is wet, immediately withdraw the cord of the socket-outlet.
- ❑ Inform potential users of these instructions.
- ❑ Never leave the appliance unsupervised when in use.
- ❑ The appliance must be used only for its intended purpose. No responsibility can be taken for any possible damage caused by incorrect use or improper handling.
- ❑ Children and persons with disabilities are not always aware of the danger posed by the use of appliances.
- ❑ This device can be used by children aged 8 years and older and adults, with reduced physical, sensory or mental capabilities or lack of experience and knowledge, if they have been given supervision or instruction concerning use of the appliance in a safe way and understand the hazards involved.

- ❑ Children shall not play with the appliance.
- ❑ Cleaning and user maintenance shall not be made by children unless they are supervised.
- ❑ Keep the appliance and its cord out of reach of children aged less than 8 years of age when it is energized or cooling down.
- ❑ This device is not a toy, do not leave children or people with disabilities to play with.
- ❑ In order to ensure your children's safety, please keep all packaging (plastic bags, boxes, polystyrene etc.) out of their reach.
- ❑ Caution ! Do not allow small children to play with the foil :  
**THERE IS A DANGER OF SUFFOCATION !**
- ❑ From time to time check the cord for damages. Never use the appliance if cord or appliance shows any signs of damage.
- ❑ Never immerse the appliance in water or any other liquid for any reason whatsoever.
- ❑ Never place it into the dishwasher.
- ❑ Never use the appliance near hot surfaces.
- ❑ Do not operate the appliance with a damaged cord or plug, or after the appliance has been damaged in any manner.
- ❑ If the supply cord or appliance is damaged, it must be replaced by the manufacturer or its service agent or a similarly qualified person in order to avoid a hazard.
- ❑ Disconnect the power source cable before any operation of cleaning of maintenance and accessories assembly.
- ❑ Never use the appliance outside and always place it in a dry environment.
- ❑ Never use accessories, which are not recommended by the producer. They could constitute a danger to the user and risk to damage the appliance.
- ❑ Never use any other connector than the one provided.
- ❑ Never move the appliance by pulling the cord. Make sure the cord cannot get caught in any way.
- ❑ Never wind the cord around the appliance and do not bend it

- Ensure that the power cord does not come into contact with hot parts of this unit.
  - Make sure the appliance has cooled down before cleaning and storing it.
  - The temperature of accessible surfaces may be very high when the appliance is operating. Never touch these parts, of apparatus, to avoid burning itself.
  - Make sure the appliance never comes into contact with flammable materials, such as curtains, cloth, etc...& the power cord and plug do not come in contact with water.
  - Before cleaning, always unplug the appliance from the power supply and let it cool down.
  - This appliance is not intended to be operated by means of an external timer or separate remote-control system.
  - Always remove the plug from the wall socket when the appliance is not in use.
  - When using an extension lead always make sure that the entire cable is unwound from the reel. Use solely CE approved extension leads. Input power must be at least 16A, 250V, 3000W.
  - Incorrect operation and improper use can damage the appliance and cause injury to the user.
  - This device, designed for home use, complies with standards relating to this type of product.
  - The item must not be left unattended when it is connected to main supply.
  - The item is not to be used, if it has been dropped or if there are visible signs of damage or if it is leaking.
  - For instructions on cleaning the unit, refer to the following section of the manual.
  - This appliance is only intended for household use.
- (\* ) Qualified Person : the manufacturer's or importer's service technician or any other person qualified, authorized and competent to carry out this type of repair.

## GENERAL INFORMATION

The symbol "OPEN BOOK" means a recommendation to read important things contained in the record.



The symbol "BIN" crossed out, abbreviation WEEE (Waste of Electrical and Electronic Equipment) means that at the end of life, it should not be discarded with household waste, but filed to the sorting of the locality. Waste recovery can help preserve our environment.



The symbol "CE" is the guarantee of compliance with harmonized European standards, voluntary, reflecting the essential requirements into technical specifications. These standards are not mandatory but are guarantees of compliance with essential requirements.



The symbol ROHS (Restriction of use of some Hazardous Substances) on the Environmental Protection, certifies that for each of the five hazardous substances • Lead • Mercury • (hexavalent) chromium • products for protection against flames PBB and PBDE, the peak concentration is equal to or less than 0.1% of the weight of homogeneous material, and 0.01% for the 6th • cadmium.



The symbol "DOUBLE SQUARE" means a double insulated. A basic insulation and supplementary insulation. This device requires no connection to the mass of a protective conductor grounded. The materials are said : double insulation class II.

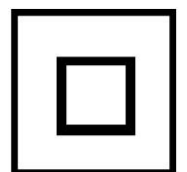

The symbol "TRIMAN" indicates that the consumer is invited to dispose the product as part of a separate collection (eg recycling bin, waste, voluntary intake point).



For more information : <http://www.quefairedemesdechets.fr>

## DESCRIPTION

1. Engine block with Handle
2. Hose / Vacuum Connection
3. Locking clips
4. Cable storage support
5. Dust and ash container
6. Plastic suction hose
7. Metal suction tube



## IMPORTANT

- Read this instruction booklet carefully.
- Always remove the plug from the power sock before opening the appliance.
- Never use methylated spirits or other solvents to clean the appliance.
- Never leave the appliance unattended when it is switched on.
- This unit is for household use only. Use as described in this instruction booklet.
- Never use the device if it appears to be defective in any way.
- For repairs or accessories. Contact your dealer or an authorized service centre.

## IMPLEMENTATION

Check that the electrical plug is disconnected from the mains.  
Open the locking tabs (3) located on the metal tank of the vacuum cleaner (5).  
Lift the engine block by the handle and check that the tank is empty.  
Replace the motor unit on the base and reattach it with the locking tabs.

Connect the metal suction tube (7) to the suction tube (6).  
Connect the other end of the hose to the suction mouth (2) on the top of the tank.

### Start / Stop

Insert the plug into a properly installed AC outlet.

To start the ash vacuum cleaner, place the On / Off switch in position "I".

To stop the ash vacuum cleaner, set the switch to the "O" position.



### FEATURES

1. Connection of the hose in vacuum cleaner mode
2. Carrying handle
3. On-off switch
4. Connection of the hose in blower mode.

This vacuum cleaner has 2 functions.

A. Vacuum

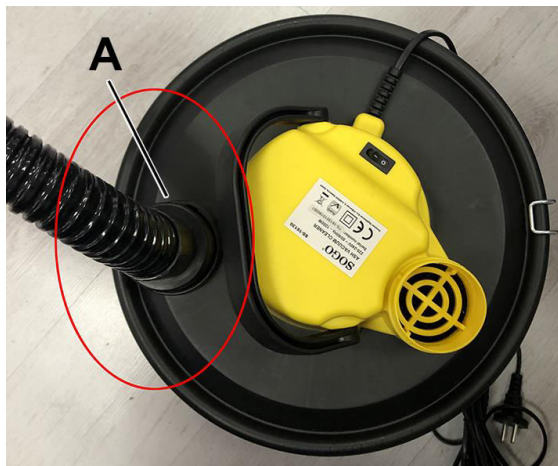

B. Blower.

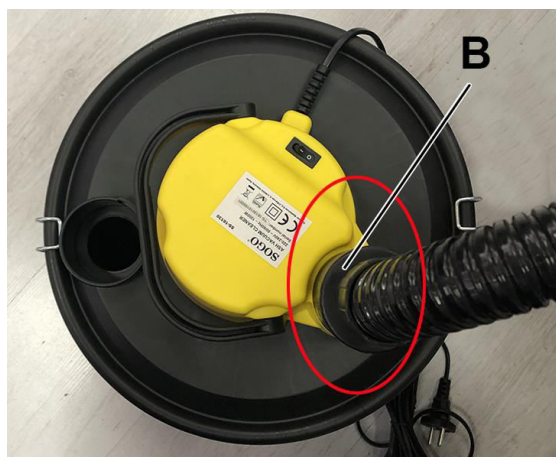

Note : The hose is internally covered with to height temperature resistant material. (about 40° C).

Depending on the chosen use, Vacuum or Blower, connect the hose to the appropriate connection.

A. Hoover. (1)

B. Blower. (4)

Place the On / Off switch in position "I" to start the appliance.

Place the switch in the "O" position to stop the appliance.

## CLEANING AND MAINTENANCE

Before cleaning, always switch off the appliance, disconnect the apparatus and let it cool.

Clean the outside of the apparatus with a sponge or slightly wet linen. (possibly with household product).

Never immerse the motor unit and the cover in water or any other liquid !

Do not use abrasive cleaners, gritting, or metal brush or another cutting object.

*Notes: Do not wash the filter in a washing machine or dry it with an hair dryer.*

*Do not clean the exterior of the vacuum cleaner with gasoline oil or any other liquid.*

*The metal tank can be washed with water and a household neutral product. Rinse and allow to dry before re-use.*

*After cleaning, stop the ash vacuum cleaner and tighten the tube suction and pipe vertically, to allow the remaining ash, into the hose, falling into the container.*

If the suction power deteriorates during use, stop the ash vacuum cleaner, open the container and empty it in a bin or suitable packaging before disposing of the unit.

### Filter cleaning

Disconnect the suction hose. Detach the cover (engine block) from the tank and turn it over on the tank or on the ground. Hold the dust filter and loosen the locking wing nut (A) to disengage the filter.

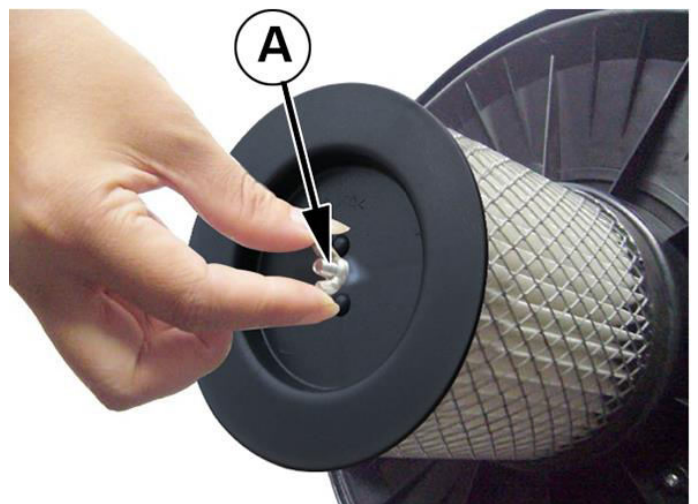

Remove the cover (1) and the dust filter (2) from the metal rod (3).

Wash the dust filter with warm clean water.  
(If necessary, use a mild detergent).  
Rinse and dry the dust filter before reinstalling it.

Note: Never use the vacuum cleaner without the filter !

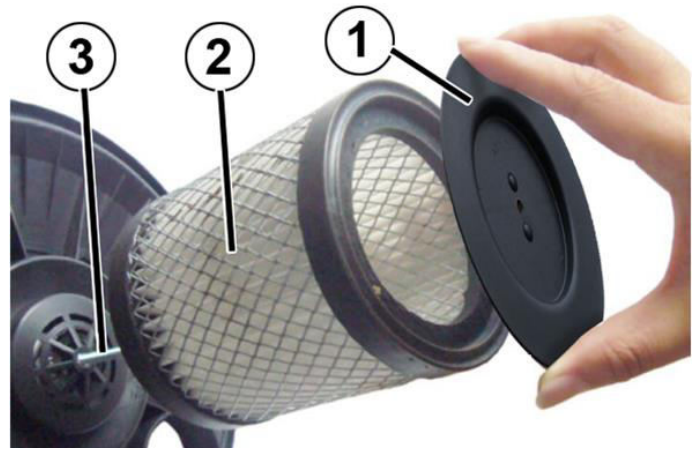

## STORAGE

- Ensure the unit is completely cool and dry.
- Do not wrap the cord around the appliance, as this will cause damage.
- Keep the appliance in a cool, dry place and out of reach from children.

## GUARANTEE

Before being delivered, all our products are subjected to a rigorous control. This apparatus is guaranteed 24 months starting from the date of purchase by the consumer.

The documents in proof of guarantee are:

- The invoice and
- The filled and stamped warrantee plate (located on side or bottom of the gift box). Without these documents in proof, no free replacement, nor no free repair, can be carried out.

During the warranty period, we deal for free, the defects of the apparatus or the accessories, rising from a defect of materials or manufacture by repair or, replacement. The services within the framework of the guarantee do not involve any extension of the warranty period and does not give right to a new guarantee! In the event of recourse to the guarantee, bring back the complete apparatus to your retailer, in its original packing, accompanied by the proofs of purchase. The breakage of parts out of glass or plastic is, in all the cases, not warranted. Defects on the accessories or the wearing parts (for example: coals of engines, hooks, drive belts, remote control of replacement, teeth brushes of replacement, webs etc) as well as cleaning, maintenance or it replacement of wearing parts are not guaranteed and are thus to pay!

In the event of foreign intervention, the guarantee becomes null and void.

After flow of the warranty period, repairs can be carried out, against payment, by a specialized trade or a repair service.

## SPECIFICATIONS

Power supply	220-240V~ 50/60Hz
Power	800-1200W
Norm	Class II
Tank capacity	20L

Made in PRC

*The characteristics can change without prior notice.*

CAUTION: In order to minimize the risks of electric shock, In the event of breakdown, not to open the case but to call upon a qualified technician for repairs.

This device complies with EC directives, it was controlled according to all current European directives, applicable such as: electromagnetic compatibility (EMC) and low voltage (LVD).

This device has been designed and manufactured in compliance with the latest regulations and technical requirements for safety.

**Imported by Sotech International  
" LE PERIPOLE " N°A-107  
33, Avenue du Marechal de Lattre de Tassigny  
94120 Fontenay sous-bois - France**